

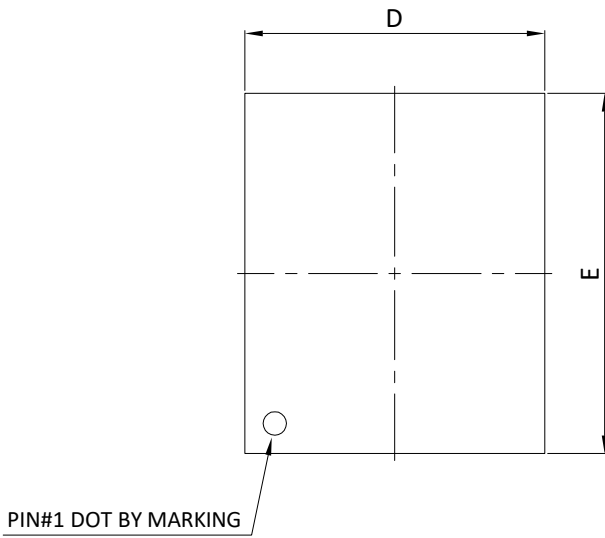

DFN5x6C_8L_EP1_S PACKAGE OUTLINE

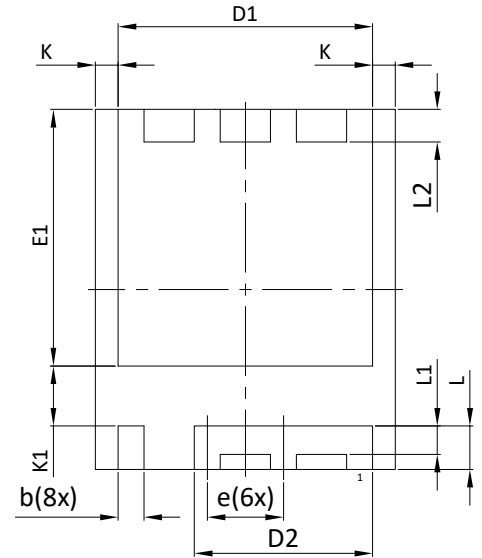

TOP VIEW



BOTTOM VIEW

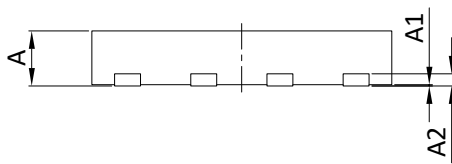

SIDE VIEW

RECOMMENDED LAND PATTERN

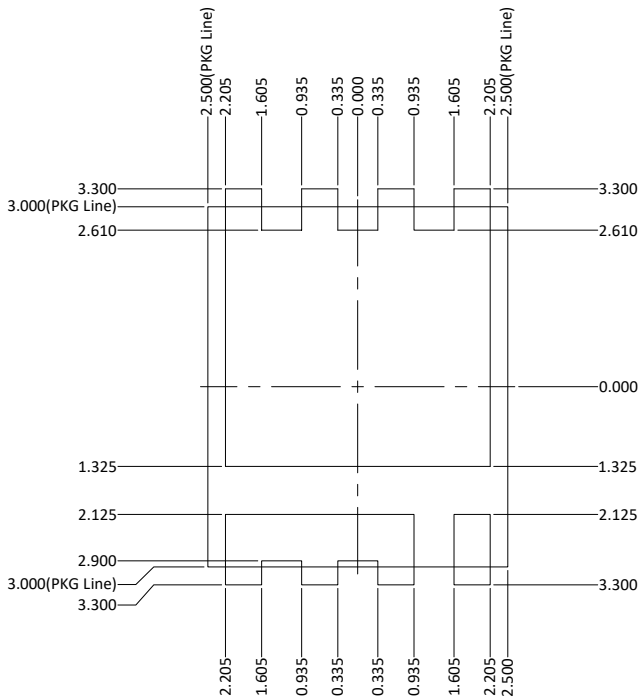

SYMBOL	DIMENSIONS IN MILLIMETERS			DIMENSIONS IN INCHES		
	MIN.	NOM.	MAX.	MIN.	NOM.	MAX.
A	0.850	0.900	0.950	0.033	0.035	0.037
A1	0.000	0.020	0.050	0.000	0.001	0.002
A2	0.203 REF			0.008 REF		
D	4.900	5.000	5.100	0.193	0.197	0.201
D1	4.140	4.240	4.340	0.163	0.167	0.171
D2	2.870	2.970	3.070	0.113	0.117	0.121
E	5.900	6.000	6.100	0.232	0.236	0.240
E1	4.175	4.275	4.375	0.164	0.168	0.172
K	0.280	0.380	0.480	0.011	0.015	0.019
K1	0.900	1.000	1.100	0.035	0.039	0.043
L	0.625	0.725	0.825	0.025	0.029	0.032
L1	0.375	0.475	0.575	0.015	0.019	0.023
L2	0.440	0.540	0.640	0.017	0.021	0.025
e	1.270 BSC			0.050 BSC		
b	0.330	0.430	0.530	0.013	0.017	0.021

UNIT: mm

NOTE

1. Dimensioning and tolerancing conform to ASME Y14.5M-1994. All dimensions are in millimeters.
2. THIS PACKAGE WAS QUALIFIED USING IR REFLOW PROCESS (JEDEC STANDARD). FOR USAGE IN OTHER SOLDERING PROCESSES, PLEASE CONTACT LOCAL AOS REPRESENTATIVES.