

DFN5x6D_8L_EP2_S PACKAGE OUTLINE

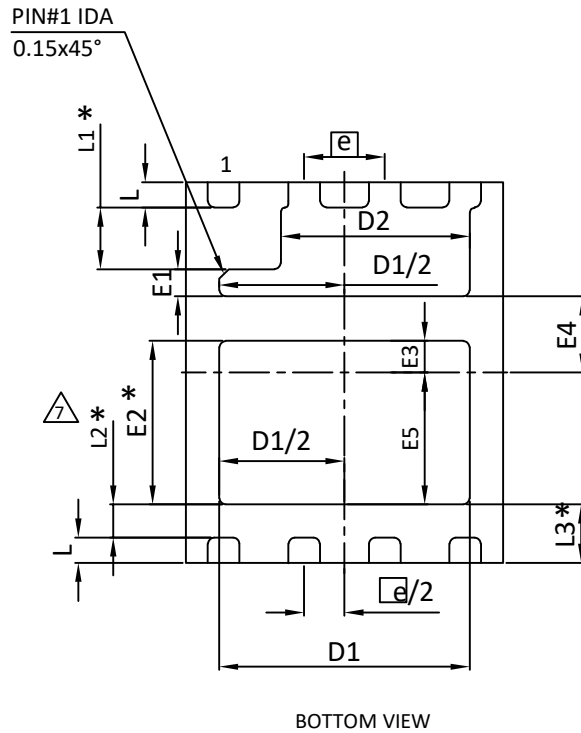

DFN5x6D_8L_EP2_S PACKAGE OUTLINE

RECOMMENDED LAND PATTERN (UNIT: mm)

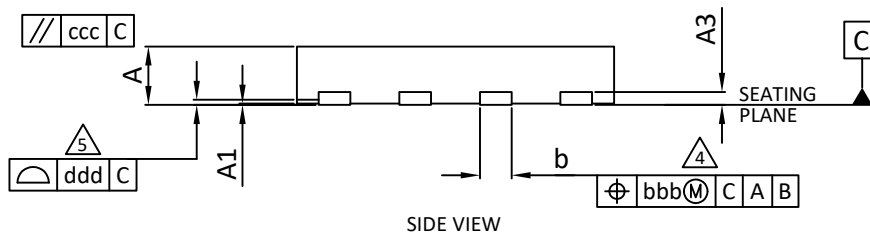
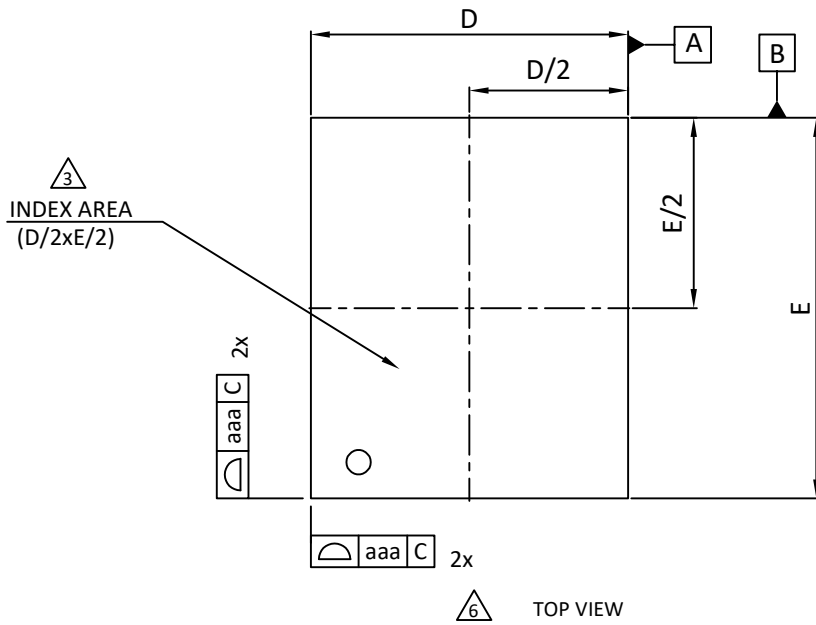
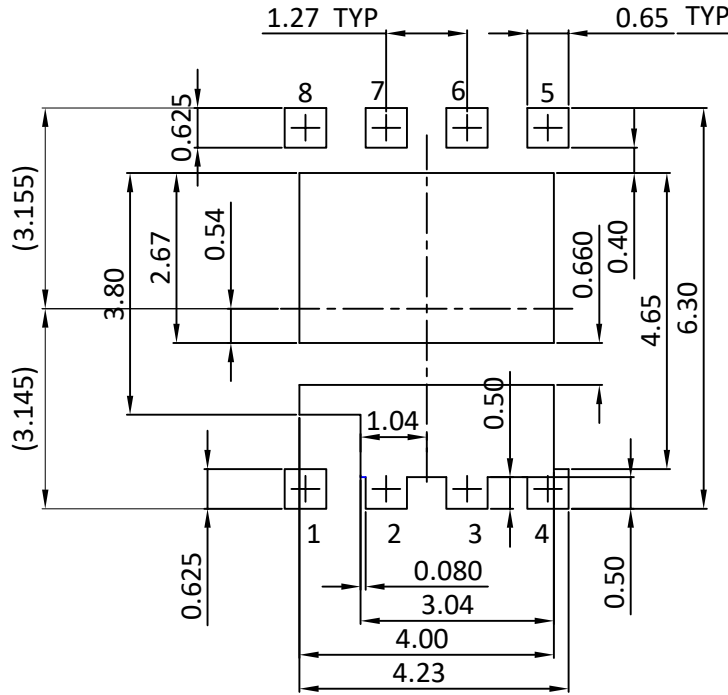

SYMBOL	DIMENSIONS IN MILLIMETERS			DIMENSIONS IN INCHES		
	MIN.	NOM.	MAX.	MIN.	NOM.	MAX.
A	0.70	0.75	0.80	0.0276	0.0295	0.0315
A1	0.00	0.02	0.05	0.000	0.001	0.002
A3	0.15	0.20	0.25	0.006	0.008	0.010
b	0.45	0.50	0.55	0.018	0.020	0.022
D	4.90	5.00	5.10	0.193	0.197	0.201
D1	3.80	3.95	4.05	0.149	0.155	0.159
D2	2.85	2.98	3.13	0.111	0.117	0.123
E	5.90	6.00	6.10	0.232	0.236	0.240
E1	0.28	0.43	0.58	0.011	0.017	0.023
E2	2.48	2.58	2.68	0.098	0.102	0.106
E3	0.35	0.50	0.60	0.014	0.020	0.024
E4	1.05	1.20	1.30	0.041	0.047	0.051
E5	1.93	2.08	2.18	0.076	0.082	0.086
Ⓢ	1.27 BSC			0.050 BSC		
L	0.30	0.40	0.50	0.012	0.016	0.020
L1	0.87	0.97	1.07	0.034	0.038	0.042
L2	0.42	0.52	0.62	0.016	0.020	0.024
L3	0.82	0.92	1.02	0.032	0.036	0.040
aaa	0.15			0.006		
bbb	0.10			0.004		
ccc	0.10			0.004		
ddd	0.08			0.003		



Document No.	PO-00199
Version	H

DFN5x6D_8L_EP2_S PACKAGE OUTLINE

NOTE:

1. DIMENSIONING AND TOLERANCING CONFORM TO ASME Y14.5M-1994.

2. ALL DIMENSIONS ARE IN MILLIMETERS.

3. THE LOCATION OF THE TERMINAL #1 IDENTIFIER AND TERMINAL NUMBERING CONVENTION CONFORMS TO JEDEC PUBLICATION 95 SPP-002.

4. DIMENSION B APPLIES TO METALLIZED TERMINAL AND IS MEASURED BETWEEN 0.15MM AND 0.30MM FROM THE TERMINAL TIP. IF THE TERMINAL HAS THE OPTIONAL RADIUS ON THE OTHER END OF THE TERMINAL, THE DIMENSION B SHOULD NOT BE MEASURED IN THAT RADIUS AREA.

5. COPLANARITY APPLIES TO THE TERMINALS AND ALL OTHER BOTTOM SURFACE METALLIZATION.

6. DRAWING SHOWN ARE FOR ILLUSTRATION ONLY.

7. THE DIMENSIONS WITH * ARE FOR REFERENCE ONLY.

8. THIS PACKAGE WAS QUALIFIED USING IR REFLOW PROCESS (JEDEC STANDARD). FOR USAGE IN OTHER SOLDERING PROCESSES, PLEASE CONTACT LOCAL AOS REPRESENTATIVES.